

top

rings to move pen

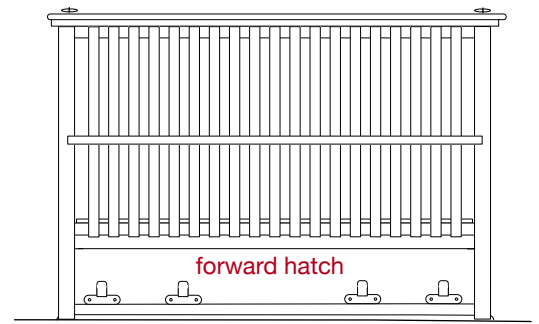

view from bow

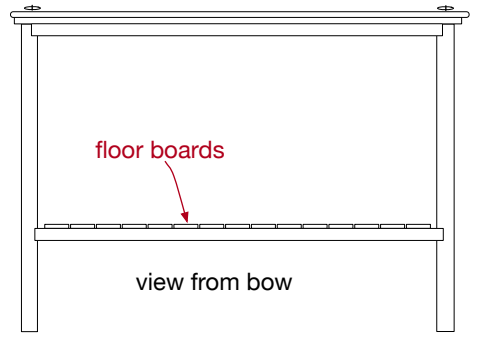

floor boards

view from bow

The design of this livestock pen is based on the 1916 Boucher model of the Flying Cloud in the Boston Museum of Fine Arts except I added a loading ramp since the pen in the model does not have a way to get the livestock in or out.

Sarah H. Bowman, a passenger on 1st voyage, reported that there were 78 people on board & that the on-board livestock included roosters, hens, turkeys, pigs, and lambs. Also, Charles Soddard in his biography *In the Footprints of the Padres*, says "A list of our live-stock: 17 pigs; 12 dozen hens and roosters; 3 turkeys; 1 gobbler; a cockatoo and a wild-cat."

Note that enough food was required for a voyage of 120 or more days.

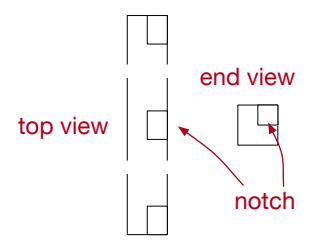

end view

top view

notch

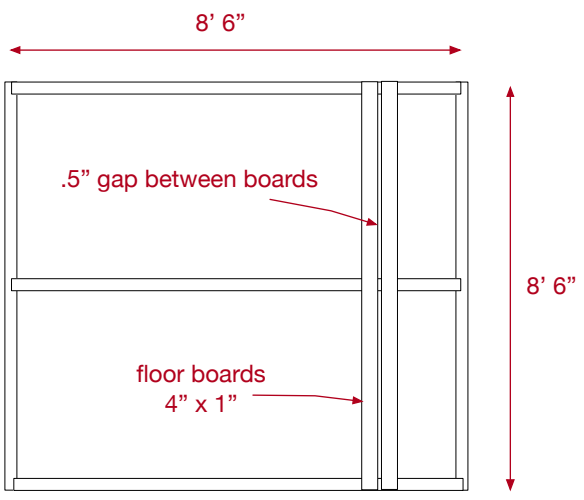

8' 6"

.5" gap between boards

floor boards
4" x 1"

8' 6"

floor & top frames 3" x 3" beams

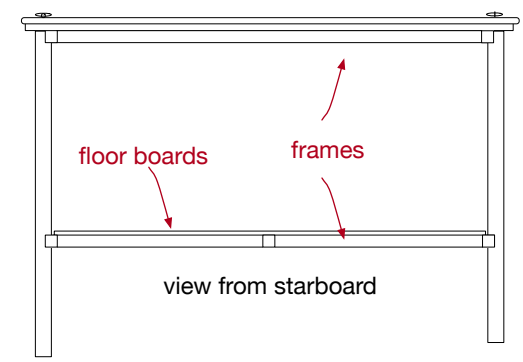

floor boards

frames

view from starboard

corner posts mahogany
roof planks sky blue
rest of pen white

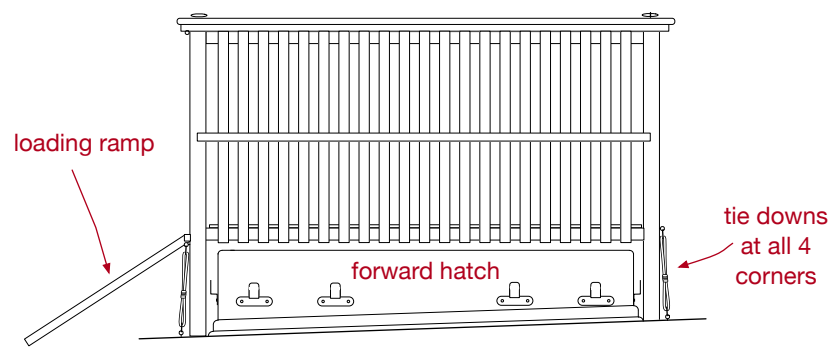

loading ramp

forward hatch

view from starboard

tie downs
at all 4
corners

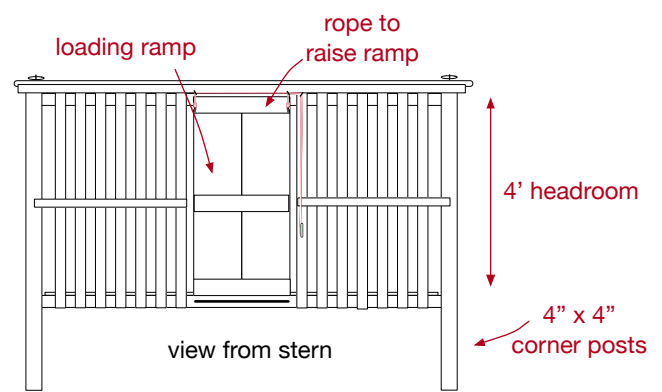

loading ramp

rope to
raise ramp

4' headroom

4" x 4"
corner posts

view from stern

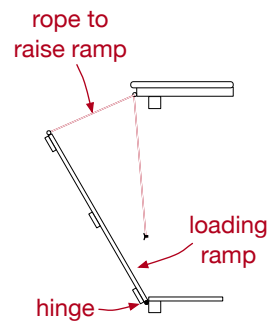

rope to
raise ramp

hinge

loading
ramp

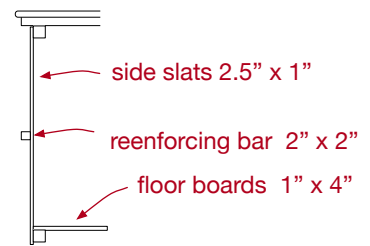

side slats 2.5" x 1"

reenforcing bar 2" x 2"

floor boards 1" x 4"

pen corner post

pen corner post

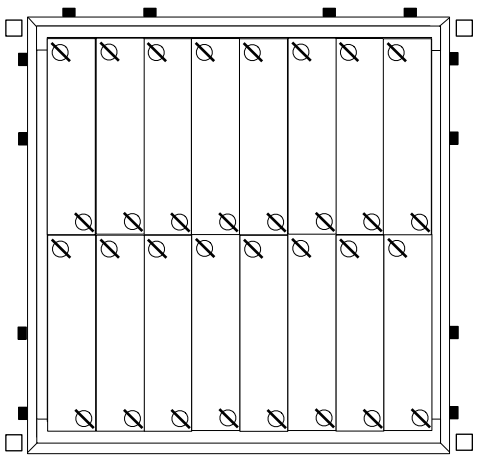

forward hatch

FLYING CLOUD - LIVESTOCK PEN